

Copyright© 2002  
MagTek®, Inc.  
Printed in the United States of America

# MICRIMAGE INSTALLATION AND OPERATION SUMMARY

RS232 - PC

Part Number 99875246-2

JUNE 2003

Information in this document is subject to change without notice. No part of this document may be reproduced or transmitted in any form or by any means, electronic or mechanical, for any purpose, without the express written permission of MagTek, Inc.

MagTek and MICRImage are registered trademarks of MagTek, Inc.

## REVISIONS

Rev Number	Date	Notes
1	05 Sep 02	Initial Release
2	13 Jun 03	Front Matter: added ISO line to logo, changed Tech Support phone number.



**MAGTEK®**

**REGISTERED TO ISO 9001:2000**

1710 Apollo Court  
Seal Beach, CA 90740  
Phone: (562) 546-6400  
FAX: (562) 546-6301  
Technical Support: (651) 415-6800  
[www.magtek.com](http://www.magtek.com)

The following is required for installation:

- MICRImage Unit
- Interface Cable
- Power Adapter

## INSTALLATION

- Connect the DB25 cable to the MICRImage Unit.
- Connect the DB9 cable to the serial port on the PC.
- Connect the power supply to the MICRImage cable.

For a single PC, install the MICRImage cables shown as follows:

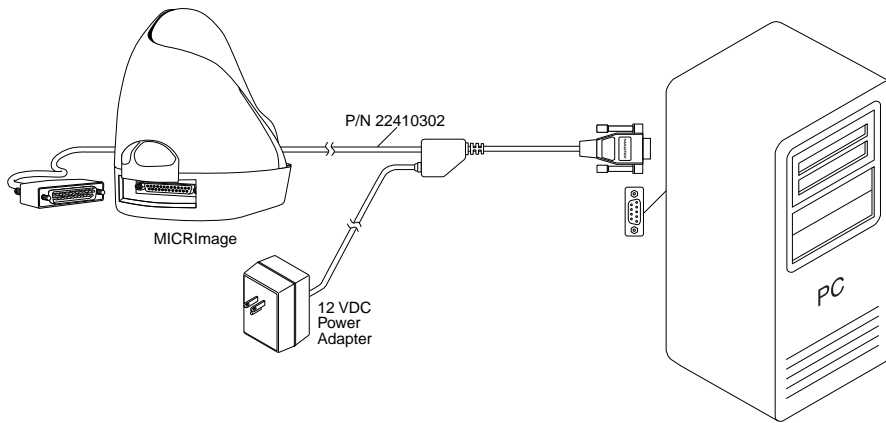

### **Caution**

*Do not place the MICRImage Reader within 6 inches of a computer monitor or power supply. These devices may cause undesirable interference with the check reading operation.*

## CHECK READING

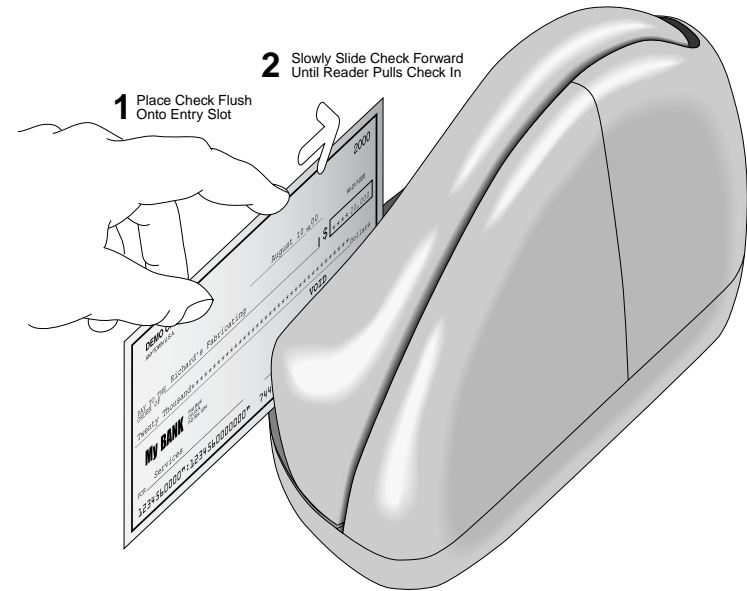

## MAGNETIC STRIPE CARD READING

